



MMS 2 MIRAGE Media Server 2-Source Digital Audio Player

Initial Setup

BEFORE YOU BEGIN, plug everything in.
Mirage Media Server detects the presence of audio cables. You must connect the analog audio output (green) to an amplifier or powered speakers before you begin using it.

Audio/Video Connections

Before you turn on your MMS-2, connect all necessary audio and video cables.

Ethernet Connections

The MMS requires a wired connection to your LAN and access to the Internet. This server is configured to obtain an IP address via DHCP automatically.

First Run

Once you have made all connections, power up the server. If you have connected video, wait for the Now Playing screen to display before configuring the server.

Browser-based Configuration

Using a computer on the same network, open the configuration utility [Figure 1] with Internet Explorer, Safari or Firefox to the default configuration address: <http://MMS-2/config>

NOTE: You can also look up the IP address of the server using the DHCP client table in your router's interface.

Automated Synchronization

In the server configuration utility, on the firmware tab, you will find links to set up the synchronization utility to automatically upload new iTunes and Windows Media Player content to your server.

Browser-based Control

To control the Mirage Media Server using a web browser, simply browse to the server address: <http://MMS-2> (default).

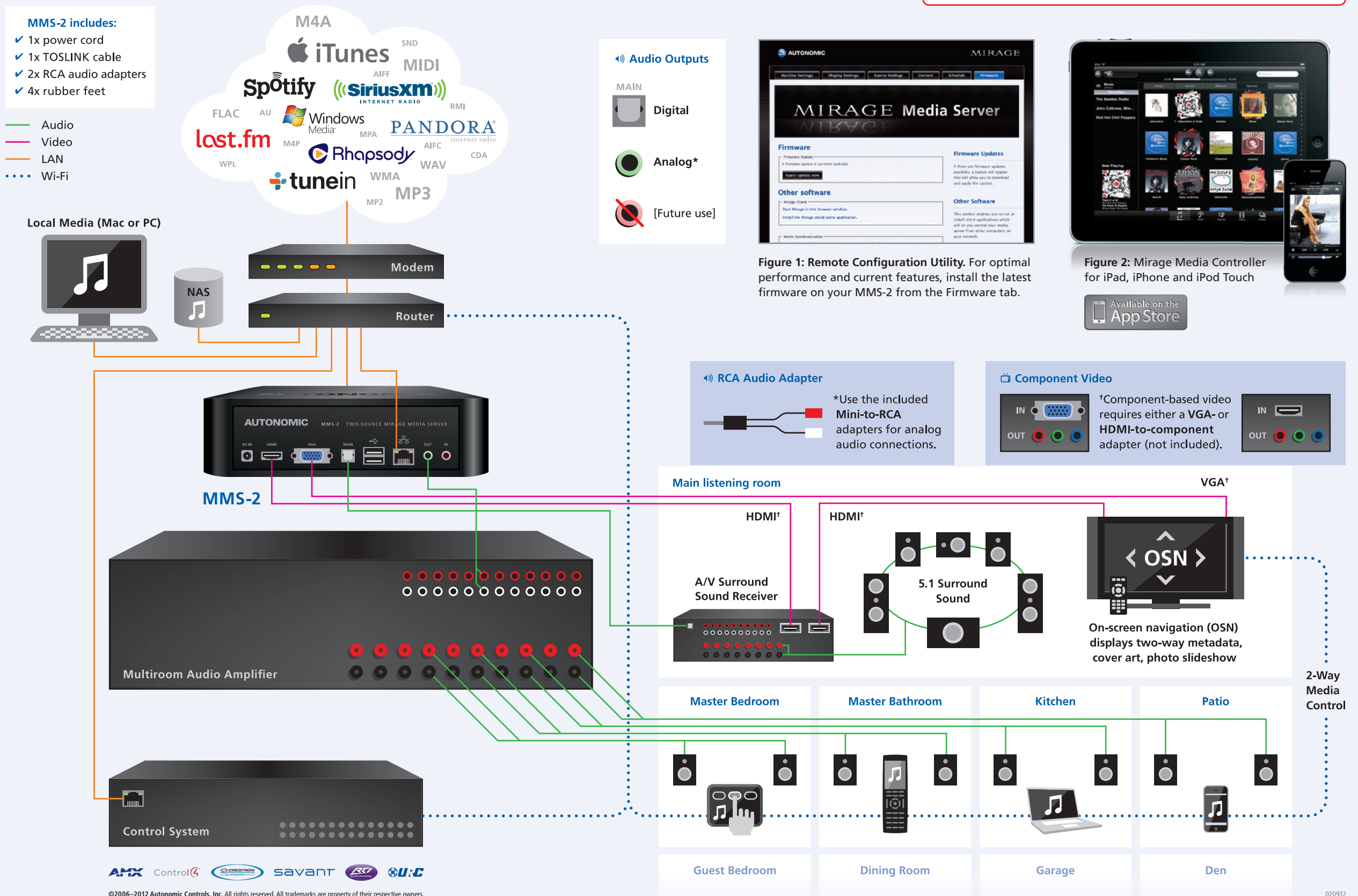

- MMS-2 includes:**
- ✓ 1x power cord
 - ✓ 1x TOSLINK cable
 - ✓ 2x RCA audio adapters
 - ✓ 4x rubber feet

- Audio
- Video
- LAN
- ... Wi-Fi



- Audio Outputs**
- MAIN
 - Digital
 - Analog*
 - [Future use]



Figure 1: Remote Configuration Utility. For optimal performance and current features, install the latest firmware on your MMS-2 from the Firmware tab.



Figure 2: Mirage Media Controller for iPad, iPhone and iPod Touch



RCA Audio Adapter

*Use the included Mini-to-RCA adapters for analog audio connections.

Component Video

*Component-based video requires either a VGA- or HDMI-to-component adapter (not included).

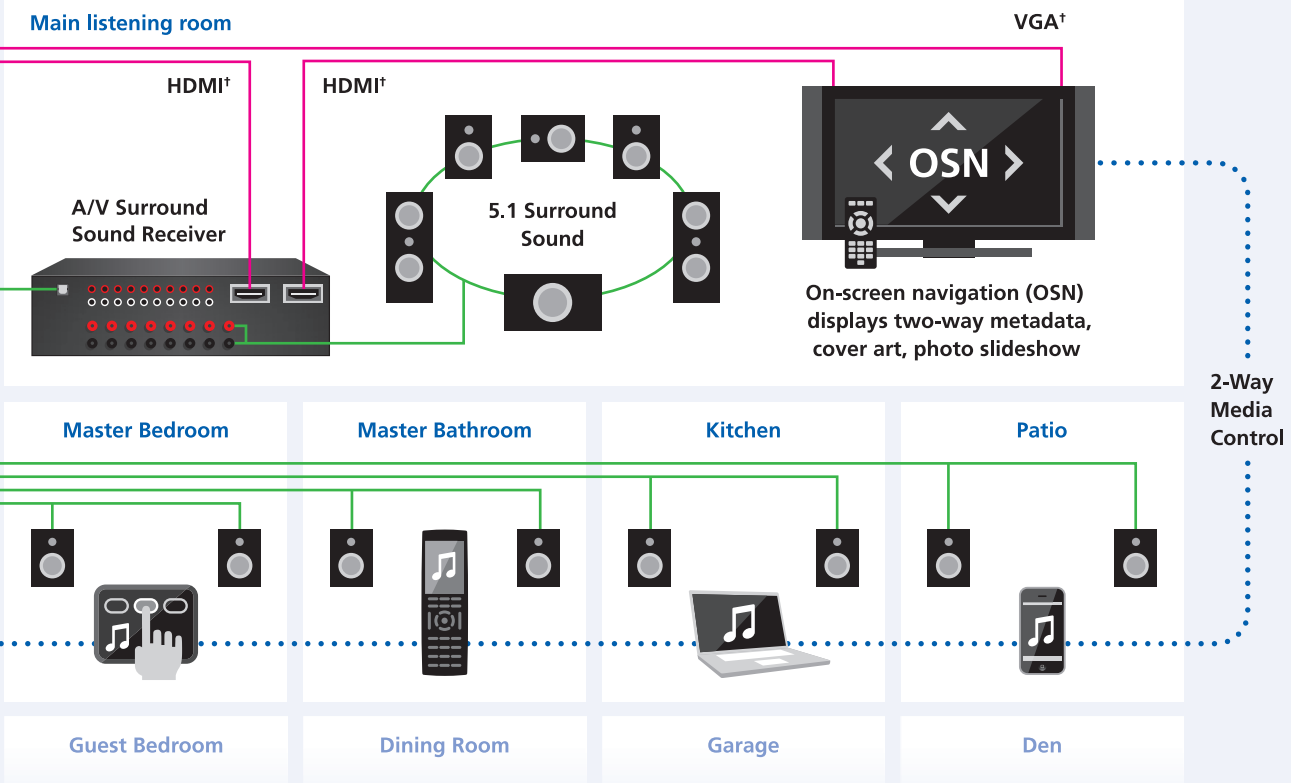

200 Business Park Drive, Suite 310
Armonk, New York 10504
914 598 1647

MirageMediaServer.com



©2006–2012 Autonomic Controls, Inc. All rights reserved. All trademarks are property of their respective owners.